

DEPADUA SCHOOL MURAL

SPONSOR FORM

This 60'x9' mural will depict 4 buildings and 20 portraits from DePadua's history. The mural will be painted by local mural artist Sue Martinsen under the oversight of the Ashland Mural Walk Project. It will be located at Super H Foods (formerly Piggly Wiggly) at 511 East Main St. Completion date will be fall of 2019

There are 2 options for supporting this mural.

1. The purchase of a building for \$1,000.00 each
2. The purchase of a portrait-either one of the 7 prechosen people or a portrait of the person of your choice for \$500.00 each

Names of the prechosen people are: Father Fabian, Norm DeBriyn, Sister Joyce, Sally Pufall, one Sister of Sacred Heart, Sister Henriella, and Bones Hulmer. If you wish to purchase one of these people, please name them on the photo form on the reverse side of this form. The name of the person in each portrait will be displayed on the mural as well as the names of the sponsors.

Purchases are on a first come first serve basis.

ORDER FORMS ON

REVERSE SIDE

FOR QUESTIONS CALL : SUE MARTINSEN 715-292-4573

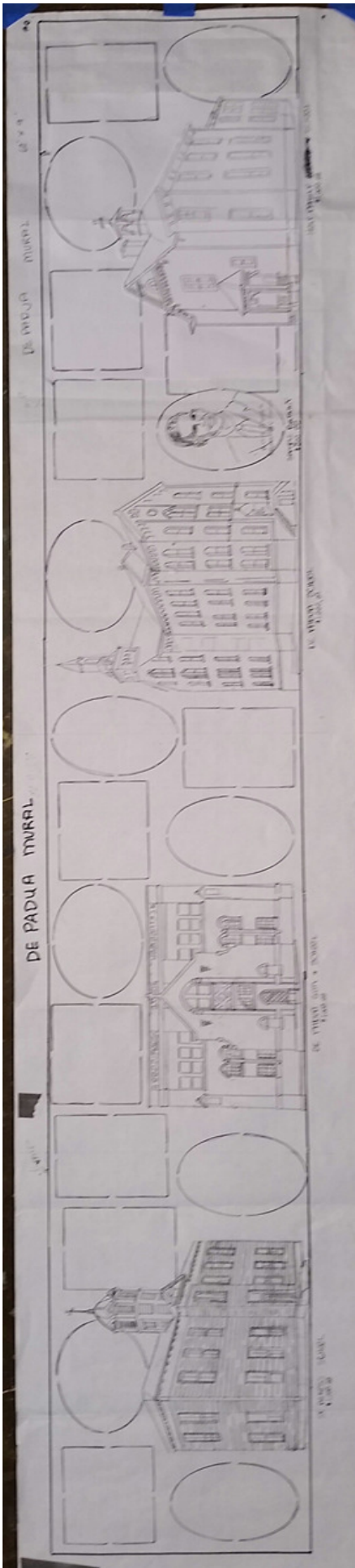

DEPADUA SCHOOL MURAL ORDER FORMS

Name of purchaser _____

Address _____

City/State/Zip _____

Phone _____ Email _____

SCHOOL BUILDING ORDER FORM: \$1,000.00 EACH

Please check building you wish to purchase

_____ Original St. Agnes School ___SOLD___ DePadua School

___SOLD___ DePadua Gym _____ Holy Family School

Name of sponsor to be placed on mural _____

PLEASE SEND PAYMENT AND ORDER FORM TO:

ASHLAND MURAL WALK, PO BOX 403, ASHLAND, WI 54806

.....

\$500.00 PORTRAIT SUBMISSION DIRECTIONS: DO NOT SEND ORIGINAL PHOTOS!!! Send large (at least 4x6), good quality copies only. The photos must be well lit, clear and readable. Wedding, yearbook, professional portraits or good quality personal photos are best. The artist reserves the right to reject any photo submissions that are not of sufficient clarity. Copies will not be returned. Please submit photos along with this form. **DO NOT SEND PAYMENT AT THIS TIME. SUE (THE ARTIST) WILL NOTIFY YOU WHETHER YOUR PHOTO HAS BEEN APPROVED AND GIVE YOU PAYMENT INSTRUCTIONS AT THAT TIME. \$500.00 each due upon approval and notification to you by artist.**

Name of person in portrait _____

Name of Sponsor to be placed on mural _____

SEND THIS FORM AND PHOTO TO:

Sue Martinsen, PO Box 841, Ashland, WI 54806

Or email to : margan49.67.con@gmail.com